



GLEDOPTO

3.5" Ultra thin 6W Downlights User Instruction



GL-D-013P

Overview

This product is a 3.5" Ultra thin 6W downlight that can be controlled using HUE, SmartThings, Tuya and other Zigbee gateways. It can also be paired with an RF remote control to adjust the down light's color, color temperature, and brightness.

3.5 "Ultra thin 6W Downlight

Parameter

Power: 6W
CRI:90-95
Hole Size:92-95MM
Light efficiency: 55LM/W
Luminous Flux: 300-350LM

PF: 0.5
Input current: 54mA Max
Output current: 350mA
Lifespan: 50000hours
Beam Angle: 120°

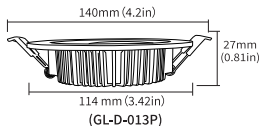

SDCM: <5
Output voltage: DC 15V
Input Voltage: AC 110~240V
Color temperature:2700~6500K
Material: Aluminum+PC Cover

Installation Steps

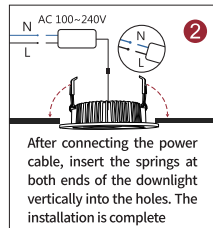
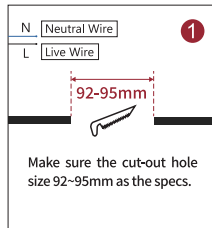

Use gateway connection

1. Connect the power supply of the ultra-thin tube light correctly.
2. Use the gateway's app to start device search. Wait for a certain period of time (see the instructions of each gateway for details). If the gateway cannot find the ultra-thin down light light, try to power it on again or reset the light.
3. After the gateway finds the ultra-thin down light, add the light to the designated room or group.
4. The setup is complete, and the light can be used.

Compatible with gateway

The product works with many ZigBee 3.0 Gateways like Philips Hue, Amazon Echo Plus or SmartThings.



Use RF remote control to connect

Pairing:

1. Power on the ultra-thin down light light (within 4 seconds, perform the next operation).
2. Press any "on" button on the RF remote control (see the instructions of each remote control for details).
3. When the ultra-thin down light gets green, it means that the connection with the remote control is successful.

Compatible 2.4G RF Remote Control



GL-RC-006Z



GL-RC-009



GL-W-001Z

Reset:

1. As shown in Figure 1:

1. Power on the ultra-thin down light.
2. Turn off the power within 2 seconds.
3. Wait for more than 5 seconds to ensure that it is completely powered off.
4. Repeat the above steps 5 times.
5. The ultra-thin down light will flash 3 times, indicating that the reset is complete.

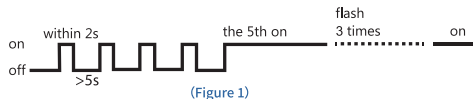

Compatible with gateway Chart

Gateways	Philips Hue	Amazon Echo Plus	Smart Things	Tuya	Conbee	Homey	Homee
Item	①	②	③	④	⑤	⑥	⑦
RGB	Yes	Yes	Yes	Yes	Yes	Yes	Yes
CCT	Yes	Yes	Yes	Yes	Yes	Yes	NO
BRIGHTNESS	Yes	Yes	Yes	Yes	Yes	Yes	Yes



①②③④⑤⑥ are already tested by GLEDOPTO, ⑦ are from our customers, just for your information, not verified by GLEDOPTO.



Attention

1. Use the product under the rated voltage. Overvoltage or undervoltage usage may cause damage.
2. Non-professional users cannot directly disassemble the product, otherwise it may cause fire or electric shock.
3. The working temperature is -20~45°C. Do not use the product in areas with direct sunlight, humidity, high temperature, etc.
4. Do not use the product in metal shielding areas and strong magnetic fields, otherwise it will seriously affect the wireless signal transmission of the product.

Disclaimers

- This manual may contain inaccuracies or discrepancies of the product operations, or typographical errors. Our company will update the contents of this manual according to the improvements and changes of product functions, and regularly improve and update the software and hardware of products described in this manual. The updates will be shown in the latest edition of this manual without further notice.
- Due to the continuous adoption of new technologies by our company, the product parameters will be changed without any notice in prior.
- This manual is only for reference and guidance for customers. It does not guarantee that it is completely consistent with the actual product. The actual application is subject to the actual product.
- The parts, components and accessories mentioned in this manual do not represent the standard configuration of the product. The detailed configuration is subject to the packing list.
- All texts, tables and pictures in this manual are protected by the relevant national laws, and may not be used without permission by supplier.
- The copyright and right of the final interpretation of this manual are reserved by our company.



LED-Trading Tobias Ebert

Schoeneicher Str. 42, Schoeneiche b. Berlin, Germany, 15566
0049 30 641 689 17 info@led-trading.de